



NATIONAL ARCHIVES OF IRELAND

NAI/PLIC/1

Archives are subject to copyright and should not be copied or reproduced
without the written permission of the Director of the National Archives

FANE VERNON—Agent.

Telephone No. 565.

Enclosures.

227
PEMBROKE ESTATES OFFICE,

1 Wilton Place,

DUBLIN.

No. 227.

September 22. 1916.

Dear Sir,

I beg to acknowledge yours of yesterday, returning Liverpool & London & Globe Insurance Company's Fire Policies Nos. 2924455 and 11690763, together with receipt in respect of the former.

Faithfully yours,

Fane Vernon.
p.p.s.

J.J. Healy, Esq.,

Secretary,

Property Losses (Ireland) Committee, 1916,

51, St. Stephen's Green, East,

Dublin.

*Put into file
9/22/16*

Earl of Pembroke
per Fane Vernon

REPORTED ON BY COMMITTEE.

18 AUG. 1916

Insurance Policies returned
as per claim also rect. for 2924455

Aug
21.9.16

Assessors Report.

Claim No. 227 Name of Claimant EARL OF PEMBROKE

Situation of Property 1, WILTON PLACE, DUBLIN

Description	Claim	Insurance (if any)	Commissioners Valuation of Buildings	Assessors Valuation of full Damage	Loss Payable on basis of Insurance	Excess of Loss over and above amount payable under the Policies
Buildings	130	4,800)	2500	130	130	N i l.
"	146)		130	130	
TOTALS, £	276 130	4,800	2500	260 130	260 130	N i l

Interests in the buildings.

W. M. ...
→

Award of Committee: Contents £260

do. Buildings WM

227

Property Losses (Ireland) Committee, 1916.

51 ST. STEPHEN'S GREEN, EAST, DUBLIN.

Claim for Damages caused during the Disturbances on the 24th April, 1916, and following days.

I Fane Verna now residing

at 1 Wilton Place in the City of Dublin

do hereby solemnly and sincerely declare that on or about the 30th day of April 1916, damage was done to the undermentioned Property, namely:—* the building of

the Estate Office and Agents House, 1 Wilton Place, Dublin.

* State situation of property damaged.

and such damage was occasioned to the best of my belief by** rifle fire

** Here state cause of damage.

from the troops

And I further declare that the Property and Articles specified on the other side were so destroyed or damaged; ~~that the Cost Price of same was as shown in each case;~~ that at the time of the destruction or damage they were respectively of the Values specified under the head "Value of Property at time of Destruction or Damage"; and that, in consequence of such destruction or damage, claim is hereby made for the sums specified under the head "Amount Claimed"; that the Claim is made by me

as agent for the Earl of Pembroke & Montgomery; and that no person is interested in the said property except † the said Earl of Pembroke & Montgomery

† Insert "Owner," "Lessee," or "Mortgagee," as the case may be.

and that it is not insured by me or any other person, § except as follows, namely:—

‡ Insert "myself," or "ourselves," and the names of Mortgagors, Mortgagees, Lessors, Lessees, or joint owners (if any).

Liverpool & London & Globe Insurance Company, Policy No. 2924455, Amount £ 4000

§ Strike out the words following if the property is not insured.

S^r do " " 11690763, " £ 800

" " " " " " £

And I make this solemn Declaration conscientiously believing the same to be true, and by virtue of the provisions of the Statutory Declarations Act, 1835.

Made and subscribed the 6th day of

July 1916, at Dublin

in the said City, of Dublin

before me, a Justice of the Peace for the said

City of Dublin

County. J. James Duggan

Signature of Claimant } Fane Verna
agent for the Earl of Pembroke

NOTE—This Claim should be accompanied by the Policies of Fire Insurance and the last receipt, in each case, or certified copies of same. When completed it is to be forwarded to the Secretary of the Committee, 51 St. Stephen's Green, East, Dublin.

PARTICULARS OF THE CLAIM.

(TO BE GIVEN IN DETAIL.)

DESCRIPTION OF PROPERTY DESTROYED OR DAMAGED.	Cost Price.			Value of Property at time of Destruction or Damage.			Value of Salvage			Amount Claimed		
	£	s.	d.	£	s.	d.	£	s.	d.	£	s.	d.
<p><i>Building of the Estate Office and Agents House 1 Wilton Place, Dublin</i></p>										130		
										146	1	8
<p><i>Amended claim.</i></p>										276	1	8
<p><i>Amended claim</i></p>	146	1	8				130					
<p><i>Carried forward.</i></p>												

*See Estimate
dated 10th May 1916
from Messrs William Beckett & Son Ltd
sent herewith.*

Tel.: - Ballsbridge 238.

COPY.

William Beckett & Son, Ltd.
Builders and Contractors,
Percy Works.

Percy Place,
Dublin.

10th May 1916.

Fane vernon, Esq., D.L.
Wilton House.

Dear Sir,

We have pleasure in enclosing our report as to damage caused by disturbances.

We estimate the total value of the damage done at £130 (one hundred and thirty pounds).

Yours faithfully,

(Signed) Wm. Beckett & Son.

William Beckett & Son Ltd.,

Contractors,

Percy Works,

Percy Place, Dublin.

10th May 1916.

Right Hon. The Earl of pembroke,

Wilton House.

The following is an Estimate of damage caused by
"Disturbances"

Safe,

Unhanging sashes, repairing and rehangng, hacking out old plate glass and supplying and glazing with new plate glass, painting outside sashes and new style.

Clerks' Office.

Hacking out broken plate glass in sash, supplying and glazing with new plate glass (segment head) painting outside of sash. Taking down shutters and backfolds, supplying and fixing new inside casing and refixing, painting inside casing.

Private Office.

Hacking out broken plate glass, supplying and glazing new plate glass in segment head of sash and 2 square plates. Taking down shutters, fixing new beaded slip, style, panel and moulding new style to backfold. Painting outside of 3 sashes and repairs to 3 shutters backfolds and slip, taking down backlining, taking asunder backlining and fixing in new panel, repairs to plastering.

Lavatory.

Hacking out old glass, supplying and glazing 2 new panes plate glass, take down shutters and backfolds, fixing new style to shutter and backfolds, painting and small repairs to wall. Take down door, supply and fix new style and rehang door, removing old architrave and supplying and fixing new.

Repairs to wall and papering in W.C.

Repairs to Telephone wire.

Inside Porch.

Hacking out old plate glass, supplying and glazing 4 new panes plate glass (two having shaped heads) unhang sash fixing new style and rehang. Taking down pilaster, architrave and jamb-lining, unhang porch door, take out and fix new style tapered and moulded, refix mortice lock, take out sash and renew style and refix supply and fix new piece glass in letter box, small repairs to wall, painting new work and patching wall paint.

Morning Room.

Hacking out old glass, supplying and glazing new pane plate glass painting outside of sash, small repairs to wall and papering.

Engineer's Office.

Take out old glass and glaze with plate glass. Repair plastering. 2 Electric light shades.

Drawing Room.

Hacking out old plate glass, supplying and glazing 3 panes plate glass, paint outside of sash.

No. 1 Bedroom.

Hacking out old 21 oz. glass, supplying and old glazing 21 oz. glass, taking out sash fixing new style and rehang sash. Taking down shutters and backfolds, fixing new style to shutter, rehang shutter and backfolds, piece architrave and moulding where

bullet went through, take down backfold, fixing new panel and rehang backfold, small repair to wall.

No. 2. Bedroom.

Hacking out old glass, supplying and glazing new panes 21 oz., take down shutter fixing in new panel and 2 styles and rehang shutter, take down door fixing in new panel and rehang door, patching bullet holes in walls.

No. 3. Bedroom.

Taking out damaged sash, making and hanging new sash glazed with 21 oz. glass. Take down shutters, fixing new styles and panels and rehang. Take down old backfolds make and fix new and rehang backfolds, fixing new architrave where damaged. Take down door, fix new muntin 2 panels, 1 lock rail, refix lock and rehang door. Paint new work. Small plaster patching to wall and ceiling.

No. 4. Bedroom.

Hacking out old glass, supply and glaze 6 panes 21 oz. glass. Remove old architraves and jamb-linings and supply and fix new. Take down door and rehang. Cut out old panel and refix new and supply and fix new slip to door frame. Paint new work and touch up old painting where disturbed. Make good plastering of walls and ceiling where damaged.

Bathroom.

Hack out and glaze 2 panes 21 oz. glass. Supply and fix new sash bar and touch up as before.

W.C.

Hack out old glass and glaze 4 panes 21 oz. glass, small patch to outside casing and repair jamb-lining, small repairs to

plastering, fixing new style and panel to door as before. Paint new work.

Staircase.

Repairs to plastering where damaged.

Mrs. Vernon's Bedroom.

Hacking out old plate glass and reglazing with 8 panes plate glass. Removing damaged architraves and fixing new. Repairs to shutters fixing 5 new styles, 1 muntin, 5 panels, 1 sash slip 1 backlining new cill to sash.

Dressing Room.

Removing damaged pilaster, making and fixing new. Piecing sash frame where damaged. Painting new work. Repairs to plastering of walls and ceiling. New panel to door as before. Fixing new style, 2 panels, 1 muntin to shutters as before. Fixing new D faced architrave where damaged, removing old.

Bedroom next Mrs. Vernon's Bedroom.

Hacking out old plate glass and reglazing 2 panes plate glass. Small repairs to joinery. Small repairs to wall plastering where damaged.

Adjoining Bedroom.

Hacking out old glass and reglazing 4 panes Plate Glass. Fix new styles to shutters and backfold as before and new panel. Painting new work. Repairs to wall plastering.

Gentlemen's Sitting Room.

Hacking out old plate glass and reglazing 6 new panes plate glass. Removing architrave where damaged and replace with new. Fix 3 new styles, 1 muntin and 2 small panels to backfolds.

Unhang door, fix new style, 1 panel, 1 muntin and refixing lock, fixing new door stops, fixing new architraves. Painting new work. Repairs to wall plastering. (No papering taken)

Externally.

Upper Window.

Take down balcony and W.G. and sash frame lead in balcony and refix sash frame and trimmings &c., fix new window stool.

W.C.

Take down sash frame and trimmings to 18" window and refix. Repairs to bullet holes in cemented flank.

Office.

Take down sashes, trimmings and frames and refix. Supplying and fixing 3 cast metal panels in balconies and paint same. Take down old window stools and supply and fix new chamfered granite cills seated. Take out bricks in front and replace with new. Repair wiggling.

Entrance.

Replace injured portions of stone to Porch cornice, base of columns &c.

Roof.

Replace broken slates, ridge tiles, chimney can &c. and solder holes in lead hips and ridges caused by bullet shots.

Door to Office.

New glaze fan light. Repair internal plaster.

Note. No painting or papering taken other than painting and touching up after repairs.

R. N. KENNEDY,

LOSS ASSESSOR.

Property Losses (Ireland) Committee, 1916.

3, College Green, No 227

Dublin, 28th July 1916.

J. J. Hely Esq.,

227

Property Losses (Ireland) Committee 1915,

DUBLIN.

Dear Sir,

RE/Claim 227, Earl of Pembroke.

Enclosed please find this claim and Five Reports, for the favor of your kind attention.

Yours faithfully,

encls.

R. N. Kennedy

Mr Kennedy,

Please see further letter dated 17th inst. + enclosures from Mr Fane Vernon, and advise your estimate of damage, if necessary.

J. J. Hely

28/7/16

F. E. VERNON—Agent.

Telephone No. 565.

Enclosures.

PEMBROKE ESTATES OFFICE,

1 Wilton Place,

DUBLIN.

227.

227

July 27. 1916.

re Damage to the building of the Estate Office and Agent's House,
1 Wilton Place, Dublin,
occasioned by rifle fire from the troops on 30th April 1916.

Dear Sir,

Referring to the above, I find that the estimate of 10th May last from Messrs. William Beckett & Son, which I submitted to you on the 6th Inst., does not cover the damage, and I therefore beg to enclose further statements, amounting to £146:1:8., as at foot, making, with the original claim, a total of £276:1:8.

I presume that these statements will be referred to Mr. Kennedy, Assessor to your Committee, who has visited and inspected the premises.

Faithfully yours,

F. E. Vernon

Messrs. Jas. Gibson & Son.	Papering and painting	£ 99:18: 0
Messrs. Wm. Beckett & Son.	Replacing damaged bricks and repairing internal woodwork	22: 0: 0
Do.	Painting flank wall	19: 6: 8
Do.	Replacing damaged portions of cast iron rain water and soil pipes	3:10: 0
Messrs. Arnott & Co.	Repairing window blinds	1: 7: 0
		<u>£146: 1: 8</u>

The Secretary,

Property Losses (Ireland) Committee, 1916.

51, St. Stephen's Green, East,

Dublin.

Office Days—Tuesdays and Fridays, from Eleven to Four o'clock.

16 1 8
130 0 0

No 5514

49, & 50, Mary Street,

DUBLIN,

26th July 1916 19

Estimate of Painting works to be done at,

227

1 WILTON PLACE,

For- Fane Vernon, Esq., D.L.

JAMES GIBSON & SON,

DECORATORS & CONTRACTORS

Merchants & Manufacturers

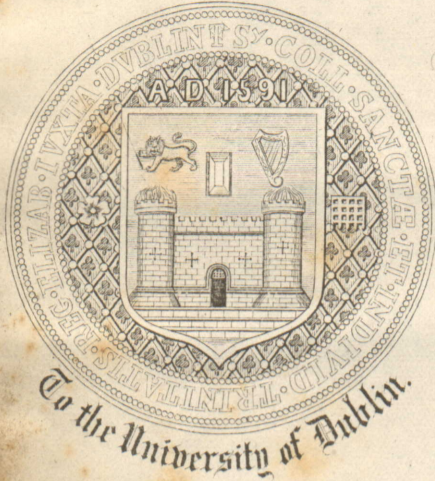

Telephone No 374.
Telegrams: "Gibsons Dublin"

INTERIOR OF OFFICES.

HALL

To repair oak paper where bullet damaged
and also part of cornice at fan.

0. 3. 6

ENGINEER'S OFFICE

Make two mahogany frames beaded &
polished, fix in perforated zink with slips and gilt mould-
ing as at present, with brass bolts etc.

Touch up and paint woodwork of
windows where damaged or repaired to match old work.

4. 17. 6

MR FANE VERNON'S OFFICE

Repair wall where damaged by bullet
to match paper, prepare, ground and paint the woodwork of
window as maple wood to match other work.

Provide 1 Pane Glass 2'-3" x 2'-4" and fix ⁱⁿ picture frame,
Fix picture in air tight.

4. 10. 0

LAVATORY & W.C.

Repair paper on walls (if paper
cannot be procured now, touch up to match) Paint new
timber to match old work and paint entire door and architrave
and door on both sides.

17. 6

DWELLING HOUSE.

FRONT HALL AS FAR AS ARCH

The ceiling and cornices to be repaired and whitened. The newly Plastered portions of walls to be covered with lead foil, touched up and walls to be painted with two coats, flatted same color as at present. The woodwork in Hall to have new portions brought to a color of the rest and all varnished.

£5. 17. 6

STUDY

The bullet mark on chimney breast to filled, touched up and brought to the color and pattern of the paper at present on.

7. 6

FRONT BEDROOM & ~~DRESSINGROOM~~

Touch up woodwork where damaged, repair and paint entire woodwork one general coat same color as at present.

£5. 15. 6 £2. 17

TWO FT. ATTIC BEDROOMS

The ceilings and cornices to be prepared and whitened. Walls to be stripped, prepared and the new paper @ 2/- per piece to be supplied and hung.

The insides of the windows, doors, architraves and skirtings to be prepared and painted with two coats.

£9. 10. 0

LARGE BACK ATTIC

The ceiling and cornice to be prepared, flats of ceiling interlined and whitened. The walls to be stripped, washed, stopped, prepared and the new paper @ 2/- per piece to be supplied and hung.

The inside of the window, its trimmings, to be prepared and painted two coats as before, floor margins stained and varnished.

£6. 15. 0

28. 5. 6

38. 14. 0

38.14.0

W.C.

The ceiling to be whitened, walls prepared and the new varnished paper at 3/6 per piece to be supplied and hung. The woodwork to window, door, architrave and skirting to be prepared and painted with two coats enamel.

£ 1- 18- 0

MRS VERNON'S BEDROOM & DRESSING ROOM

The ceiling and cornices to be washed, prepared and the new ceiling paper to be hung, including ceiling paper at 1/6 per piece, cornices to be whitened.

The walls to be stripped, prepared and the new paper at 2/6 per piece, to be supplied and hung on Bedroom. The walls of Dressing room to be sheeted with interlining paper and colored in washable distemper.

The inside of the windows, to be prepared and painted with two general coats enamel a shade to accord with the new paper. The new timber to receive two extra coats of paint.

Floor margins to be stained and varnished.

£ 16- 10- 0

VISITOR'S ROOM

To be treated as last described.

£ 8- 0- 0

MR VERNON'S BEDROOM

To Be treated as last described.

£ 8- 6- 0

SCHOOL ROOM

The ceiling and cornice to be prepared as above and whitened. The walls stripped, interlined and colored in distemper a shade to be selected. The woodwork and doors to be prepared and painted with two coats flatted to accord. The floor margins stained and varnished. The walls of Porch entering to Governess' room to be touched up.

£ 7- 15- 6

42.96

81.30

81.3.6

BEDROOM CORRIDOR.

The ceiling to be prepared as last and whitened. The walls stripped, washed, prepared and the new paper included at 2/- per piece to be hung. The outsides of the doors, architraves, and skirtings insides of the windows, its trimmings to be prepared, touched up and painted with two general coats.

£ 7.0.0

Front Drawing Room

damaged wall to be filled touched up and that wall to be painted two coats same color as other walls.

£ 1.2.0

EXTERIOR

HALL DOOR

To be prepared and painted with three coats finished green, varnished.

£ 1.2.6

9.4.6

James P. Moor

90.8.0

49, & 50, Mary Street,

DUBLIN,

27th July 1916

No. 5515.

Additional ESTIMATE OF PAINTING WORKS TO BE DONE AT,

227

1 WILTON PLACE,

FOR) FANE VERNON ESQ., D.L.

JAMES GIBSON & SON,
DECORATORS & CONTRACTORS
Merchants & Manufacturers.

Telephone N° 374.
Telegrams: "Gibsons Dublin"

ESTIMATE NO. 5514

£ 90 - 8 - 0

ATTIC STAIRCASE

The ceiling to be washed, prepared and whitened, skylight painted with two coats. The walls to be washed, prepared and colored in washable distemper. The outsides of the doors, architraves and skirtings to be prepared and painted with two coats same shade as at present, finished Enamel. Balusters, string boards, stair margins as before two coats. Handrail polished.

£ 9 - 10 - 0

£ 99 18 - 0

James Gibson & Son

mm

WILLIAM BECKETT & SON, Ltd.

Builders and Contractors,

PERCY WORKS.

Tel.:—BALLSBRIDGE 238.

PERCY PLACE,

DUBLIN, 27/7/1915. 191.....

Fane Vernon Esq. D.L.

Pembroke Estate Office.

re Rebellion Damage.

227

Dear Sir,

WE estimate the value of the work not taken in our former estimate at twenty two pounds stg. £22.0.0.

The work is as follows:-

Wilton Place Front.

Take out damaged Portland cill and supply and fix new to correspond, including making good jambs etc. Repair or replace damaged bricks. Include in last for two thrust out scaffolds and one sling from roof.

Office Front.

Supply and fix No. 7 cast metal panels fixed and painted including cutting out old.

Internally.

Sundry joinery repairs omitted as pointed out. These taken to cover all damage.

Yours faithfully,

W. Beckett for.

We enclose schedule of joinery repairs

27 July

Schedule of pending repairs referred to.Top N.C.

Head of Architrave removed and replaced.

Top Back Room

Take out work, repair work bar and rehang.

Bathroom

Supply and fix new windows ship.

Front Drawing Room.

Take down shutter, fix new stile, and replace.

Thin Rooms Room

Take down door, fix new panel and rehang

do. cupboard doors, fit three new stiles

and one new panel and do.

WMB

WILLIAM BECKETT & SON, Ltd.

Builders and Contractors,

PERCY WORKS.

Tel.:—BALLSBRIDGE 238.

PERCY PLACE,

DUBLIN, 25th July.....1916

Fane Vernon Esq, D. L,

Wilton Place,

227

Dear Sir

We propose to erect scaffolding to portion of
the external face of the flank wall of your house No 1
Wilton Place,

Wash down the entire wall & chimney shafts, and
Paint same with Two coats of best white lead paint,
For the sum of Nineteen pounds Six 8 Eight pence stg

£19.6.8

Yours faithfully

William Beckett & Son

Note

This work is necessary, because of damage caused by
gun firing,

No 3.

No 1 Wilton Place And Pembroke Estate Office,

WILLIAM BECKETT & SON
LIMITED.
CONTRACTORS,
PERCY WORKS,
PERCY PLACE, DUBLIN.

Take down one Hopper head, Rain water pipe, Portion of Soil pipe,
Supply and fix Hopper head, One length of Down pipe, One length
of Soil pipe, Refix portions of old pipes, Soil pipe to have leaded
joints, Scaffolding included,

£ 3.10.0

William Beckett & Son

On inspecting the above-mentioned rain water and soil pipes from the
scaffolding, they have been found to be pierced with bullet holes.

Wm

REGISTERED TELEGRAPHIC ADDRESS,
ARNOTT, DUBLIN."

TELEPHONES: -
COUNTING HOUSE, 302.
WAREHOUSE, 2565.



W. Leake & Co. Dublin.

DUBLIN

July 1916

Mr. Hantle The Earl of Pembroke

of Paul Simon Esq. Wellington
ARNOTT & CO. DUBLIN LTD.

1916

2739

May 22

6 Buff Halland
Office Blinds!
Blind altered

£ 17.0

WILLIAM BECKETT & SON, Ltd.

Builders and Contractors,

PERCY WORKS.

Tel.:—BALLSBRIDGE 238.

PERCY PLACE,

DUBLIN, 10th May 1916.

Stane Vernon Esq D. L.
Wilton House

Dear Sir

We have pleasure in enclosing our report
as to damage caused by disturbances.

We estimate the total value of the damage
done at £130 (one hundred & thirty pounds)

Yours faithfully
W. Beckett & Son.

William Beckett & Son Ltd.,
Contractors,
Percy Works,
Percy Place, Dublin.

10th May 1916.

Right Hon. The Earl of Pembroke,
Wilton House.

The following is an Estimate of damage caused by
"Disturbances"

Safe.

Unhanging sashes, repairing and rehanging, hacking out old plate glass and supplying and glazing with new plate glass, painting outside sashes and new style.

Clerks' Office.

Hacking out broken plate glass in sash, supplying and glazing with new plate glass (segment head) painting outside of sash. Taking down shutters and backfolds, supplying and fixing new inside casing and refixing, painting inside casing.

Private Office.

Hacking out broken plate glass, supplying and glazing new plate glass in segment head of sash and 2 square plates. Taking down shutters, fixing new beaded slip, style, panel and moulding new style to backfold. Painting outside of 3 sashes and repairs to 3 shutters backfolds and slip, taking down backlining, taking asunder backlining and fixing in new panel, repairs to plastering

Lavatory.

Hacking out old glass, supplying and glazing 2 new panes plate glass, take down shutters and backfolds, fixing new style to shutter and backfolds, painting and small repairs to wall. Take down door, supply and fix new style and rehang door, removing old architrave and supplying and fixing new.

Repairs to wall and papering in W.C.

Repairs to Telephone wire.

Inside Porch.

Hacking out old plate glass, supplying and glazing 4 new panes plate glass (two having shaped heads) unhang sash fixing new style and rehang. Taking down pilaster, architrave and jamb-lining, unhang porch door, take out and fix new style tapered and moulded, refix mortice lock, take out sash and renew style and refix supply and fix new piece glass in letter box, small repairs to wall, painting new work and patching wall paint.

Morning Room.

Hacking out old glass, supplying and glazing new pane plate glass painting outside of sash, small repairs to wall and papering.

Engineer's Office.

Take out old glass and glaze with plate glass. Repair plastering
2 Electric light shades.

Drawing Room.

Hacking out old plate glass, supplying and glazing 3 panes plate glass, paint outside of sash.

No. 1. Bedroom.

Hacking out old 21 oz. glass, supplying and old glazing 21 oz. glass, taking out sash fixing new style and rehang sash. Taking down shutters and backfolds, fixing new style to shutter, rehang shutter and backfolds, piece architrave and moulding where

bullet went through, take down backfold, fixing new panel and rehang backfold, small repair to wall.

No. 2. Bedroom.

Hacking out old glass, supplying and glazing new panes 21 oz., take down shutter fixing in new panel and 2 styles and rehang shutter, take down door fixing in new panel and rehang door, patching bullet holes in walls.

No. 3. Bedroom.

Taking out damaged sash, making and hanging new sash glazed with 21 oz. glass. Take down shutters, fixing new styles and panels and rehang. Take down old backfolds make and fix new and rehang backfolds, fixing new architrave where damaged. Take down door, fix new muntin 2 panels, 1 lock rail, refix lock and rehang door. Paint new work. Small plaster patching to wall and ceiling.

No. 4. Bedroom.

Hacking out old glass, supply and glaze 6 panes 21 oz. glass. Remove old architraves and jamb linings and supply and fix new. Take down door and rehang. Cut out old panel and refix new and supply and fix new slip to door frame. Paint new work and touch up old painting where disturbed. Make good plastering of walls and ceiling where damaged.

Bathroom.

Hack out and glaze 2 panes 21 oz. glass, Supply and fix new sash bar and touch up as before.

W.C.

Hack out old glass and glaze 4 panes 21 oz. glass, small patch to outside casing and repair jamblining, small repairs to

plastering, fixing new style and panel to door as before. Paint new work.

Staircase.

Repairs to plastering where damaged.

Mrs. Vernon's Bedroom.

Hacking out old plate glass and reglazing with 8 Panes Plate Glass. Removing damaged architraves and fixing new. Repairs to shutters fixing 5 new styles, 1 muntin, 5 panels, 1 sash slip 1 backlining new cill to sash

Dressing Room.

Removing damaged pilaster, making and fixing new. Piecing sash frame where damaged. Painting new work. Repairs to plastering of walls and ceiling. New panel to door as before. Fixing new style, 2 panels, 1 muntin to shutters as before. Fixing new D faced architrave where damaged, removing old.

Bedroom next Mrs. Vernon's Bedroom.

Hacking out old plate glass and reglazing 2 panes plate glass. Small repairs to joinery. Small repairs to wall plastering where damaged.

Adjoining Bedroom.

Hacking out old glass and reglazing 4 panes Plate Glass. Fix new styles to shutters and backfold as before and new panel. Painting new work. Repairs to wall plastering.

Gentlemen's Sitting Room.

Hacking out old plate glass and reglazing 6 new panes plate glass. Removing architrave where damaged and replace with new. Fix 3 new styles, 1 muntin and 2 small panels to backfolds. Unhang

door, fix new style, 1 panel, 1 muntin and refixing lock, fixing new door stops, fixing new architraves. Painting new work. Repairs to wall plastering. (No papering taken)

Externally.

Upper Window.

Take down balcony and W.G. and sash frame lead in balcony and refix sash frame and trimmings &c., fix new window stool.

W.C.

Take down sash frame and trimmings to 18" window and refix. Repairs to bullet holes in cemented flank.

Office.

Take down sashes, trimmings and frames and refix. Supplying and fixing 3 cast metal panels in balconies and paint same. Take down old window stools and supply and fix new chamfered granite cills seated. Take out bricks in front and replace with new. Repair wiggling.

Entrance.

Replace injured portions of stone to Porch cornice, base of columns &c.

Roof.

Replace broken slates, ridge tiles, chimney can &c. and solder holes in lead hips and ridges caused by bullet shots.

Door to Office

New glaze fan light. Repair internal plaster.

Note.

No painting or papering taken other than painting and touching up after repairs.

L. 130

NAMES OR PLAN.

44

227

Street.

No.

OCCUPIER AND IMMEDIATE LESSOR.

Street. Map.

Extract

from Valuer's Official Note Book
giving Tax + Estimate of the
Structural Value
of

1. Wilton Place

Wilton Place
Street.

Fitzwilliam Ward.

O.S. 78 Street No. 1 Map No.

- 1 Occupier. *Fane Vernon*
- 2 Immediate Lessor. *Barlof Pembroke*
- 3 Description of Tenement. *No. offsgar.*
- 4 Approximate Age. *Old.*
- | | Frontage | Depth | Height | Cube Contents |
|---|---------------|-------|--------|---------------|
| 5 | <i>25 1/2</i> | | | |
| | " | " | " | " |
| | " | " | " | " |
| | " | " | " | " |
- 6 Description of Walls and Roof.
- 7 No. of Storeys, excluding Basement.
- 8 No. of Sitting-rooms and Bed-rooms, excluding Kitchen.
- 9 If Offices, Warerooms, &c.—No. of rooms in each letting.
- 10 State whether fitted with Gas and Bath-room.
- 11 Full Rent paid.
- 12 Do. if let in tenements.
- 13 Actual or Estimated Ground Rent or Head Rent.
- 14 Actual or Estimated Cost of Construction.
- 15 Reputed Price if Purchased.
- 16 Expenditure by Occupier on purchased or leased premises.
- 17 If Lease, state date, time to run, and fine, if any.
- 18 Repairs—by whom done, and to what extent.
- 19 Insurance—by whom paid.
- 20 Rates paid by Landlord, if any.
- 21 Area of Land, if one rood and upwards.
- 22 General Remarks.
- 23 Valuation and how arrived at. *£90.*

NAMES OR PLAN.

Street.

No.		OCCUPIER AND IMMEDIATE LESSOR.
Street.	Map.	

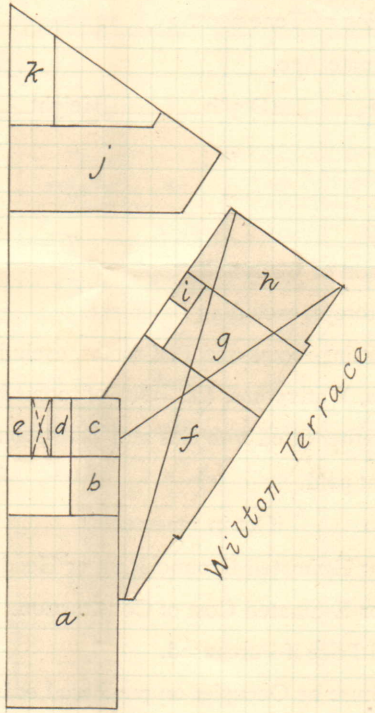

Wilton Place

Reference to Plan	Materials		Frontage	Depth	Height	Cubic Feet	Price
	walls	Roof					
a	Brick	Slate	25½'	44'	63'	70686	} 5 ^d ..
b	"	"	10'	13'	28'	3640	
c	"	"	11'	12'	28'	3696	
d	"	Flag	5'	12'	9'	540	
e	"	"	5'	12'	9'	540	

See Over.

Wilton Place Street.

Fitzwilliam Ward.

O.S. 78 Street No. 1 Map No. _____

- 1 Occupier.
- 2 Immediate Lessor.
- 3 Description of Tenement.
- 4 Approximate Age.

}	Frontage _____	Depth _____	Height _____	Cube Contents _____
	" " " "	" " " "	" " " "	" " " "
	" " " "	" " " "	" " " "	" " " "
	" " " "	" " " "	" " " "	" " " "

- 5 Description of Walls and Roof.
- 6 No. of Storeys, excluding Basement.
- 7 No. of Sitting-rooms and Bed-rooms, excluding Kitchen.
- 8 If Offices, Warerooms, &c.—No. of rooms in each letting.
- 9 State whether fitted with Gas and Bath-room.
- 10 Full Rent paid.
- 11 Do. if let in tenements.
- 12 Actual or Estimated Ground Rent or Head Rent.
- 13 Actual or Estimated Cost of Construction.
- 14 Reputed Price if Purchased.
- 15 Expenditure by Occupier on purchased or leased premises.
- 16 If Lease, state date, time to run, and fine, if any.
- 17 Repairs—by whom done, and to what extent.
- 18 Insurance—by whom paid.
- 19 Rates paid by Landlord, if any.
- 20 Area of Land, if one rood and upwards.
- 21 General Remarks.
- 22 Valuation and how arrived at.

GENERAL VALUATION OFFICE
 DUBLIN.
 ◀ 27 JUL 1818 ▶
 Certificate No. 7887

No Fee

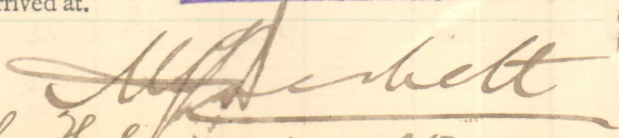
 for the Commission of Valuation.

JP

Street.

Continued

No.

OCCUPIER AND IMMEDIATE LESSOR.

Street. Map.

Reference to Plan Materials Frontage, Depth, Height Culic Feet Price

	Walls	Roof					
Basement f	Thammas Work, Bricks	Slate	30' Av.	31'	10'	9300 ✓	3 1/2 ^d
First floor f	"	"	30' Av.	31'	11'	10230 ✓	5 ^d
Basement g	"	"	17'	27 1/2'	10'	4675 ✓	3 1/2 ^d
First floor g	"	"	17'	27 1/2'	11'	5142 ✓	5 ^d
First floor h	Brick	"	17'	31'	11'	5797 ✓	5 ^d
Basement i	"	"	3 1/2'	4 1/2'	10 1/2'	165 ✓	3 1/2 ^d
j	"	"	44' Av.	19 1/2'	18'	15444 ✓	2 1/4 ^d
k	slating only	"	10 1/2'	22' Av.	-	sq. feet } 231	40¢ per sq.

Estimated Structural Value say \$2500.

Street.

Ward.

O.S.

Street No.

Map No.

- 1 Occupier.
- 2 Immediate Lessor.
- 3 Description of Tenement.
- 4 Approximate Age.
- 5

Frontage	Depth	Height	Cube Contents
"	"	"	"
"	"	"	"
"	"	"	"
- 6 Description of Walls and Roof.
- 7 No. of Storeys, excluding Basement.
- 8 No. of Sitting-rooms and Bed-rooms, excluding Kitchen.
- 9 If Offices, Warerooms, &c.—No. of rooms in each letting.
- 10 State whether fitted with Gas and Bath-room.
- 11 Full Rent paid.
- 12 Do. if let in tenements.
- 13 Actual or Estimated Ground Rent or Head Rent.
- 14 Actual or Estimated Cost of Construction.
- 15 Reputed Price if Purchased.
- 16 Expenditure by Occupier on purchased or leased premises.
- 17 If Lease, state date, time to run, and fine, if any.
- 18 Repairs—by whom done, and to what extent.
- 19 Insurance—by whom paid.
- 20 Rates paid by Landlord, if any.
- 21 Area of Land, if one rood and upwards.
- 22 General Remarks.
- 23 Valuation and how arrived at.

Street.

Ward.

O.S.

Street No.

Map No.

- 1 Occupier.
- 2 Immediate Lessor.
- 3 Description of Tenement.
- 4 Approximate Age.
- 5 {

Frontage	Depth	Height	Cube Contents
- 6 Description of Walls and Roof.
- 7 No. of Storeys, excluding Basement.
- 8 No. of Sitting-rooms and Bed-rooms, excluding Kitchen.
- 9 If Offices, Warerooms, &c.—No. of rooms in each letting.
- 10 State whether fitted with Gas and Bath-room.
- 11 Full Rent paid.
- 12 Do. if let in tenements.
- 13 Actual or Estimated Ground Rent or Head Rent.
- 14 Actual or Estimated Cost of Construction.
- 15 Reputed Price if Purchased.
- 16 Expenditure by Occupier on purchased or leased premises.
- 17 If Lease, state date, time to run, and fine, if any.
- 18 Repairs—by whom done, and to what extent.
- 19 Insurance—by whom paid.
- 20 Rates paid by Landlord, if any.
- 21 Area of Land, if one rood and upwards.
- 22 General Remarks.
- 23 Valuation and how arrived at.

Property Losses (Ireland) Committee, 1916.

51 ST. STEPHEN'S GREEN, EAST, DUBLIN.

Claim for Damages caused during the Disturbances on the 24th April, 1916, and following days.

I We Fane Vernon now residing

at 1 Wilton Place in the City of Dublin County of

do hereby solemnly and sincerely declare that on or about the 30th day of April 1916, damage was done to the undermentioned Property, namely:—*

the Building of the estate office, and Agent's House, 1 Wilton Place, Dublin.

and such damage was occasioned to the best of my belief by** Riffe Fire from the troops.

* State situation of property damaged.
** Here state cause of damage.

And I We further declare that the Property and Articles specified on the other side were so destroyed or damaged; that the Cost Price of same was as shown in each case; that at the time of the destruction or damage they were respectively of the Values specified under the head "Value of Property at time of Destruction or Damage"; and that, in consequence of such destruction or damage, claim is hereby made for the sums specified under the head "Amount Claimed"; that the Claim is made by me as agent for the Earl of Pembroke & serving with the British Exp. Force in France. Montgomery who is at present and that no person is interested in the said property except † the said Earl of Pembroke and Montgomery

† Insert "Owner," "Lessee," or "Mortgagee," as the case may be.
‡ Insert "myself," or "ourselves," and the names of Mortgagors, Mortgagees, Lessors, Lessees, or joint owners (if any).

and that it is not insured by me or any other person, § except as follows, namely:—

<u>Liverpool L. & Globe.</u>	Company, Policy No. <u>2924455</u> ,	Amount £ <u>4000</u>
<u>do.</u>	" " <u>11690763</u> ,	" £ <u>800</u>
	" " _____,	" £ _____

§ Strike out the words following if the property is not insured.

And I We make this solemn Declaration conscientiously believing the same to be true, and by virtue of the provisions of the Statutory Declarations Act, 1835.

Made and subscribed the 6th day of

July 1916, at Dublin

in the said City, County, before me, a Justice of the Peace for the said City County.

Signature of Claimant } Fane Vernon
of Claimants } Agent for the Earl of Pembroke. J. Hume Dudgeon

NOTE—This Claim is to be furnished in duplicate, and should be accompanied by the Policies of Fire Insurance and the last receipt, in each case, or certified copies of same. When completed it is to be forwarded to the Secretary of the Committee, 51 St. Stephen's Green, East, Dublin.

PARTICULARS OF THE CLAIM.

(TO BE GIVEN IN DETAIL.)

DESCRIPTION OF PROPERTY DESTROYED OR DAMAGED.	Cost Price.			Value of Property at time of Destruction or Damage.			Value of Salvage.			Amount Claimed.		
	£	s.	d.	£	s.	d.	£	s.	d.	£	s.	d.
<p>Building of the Estate office and Agent's House, 1 Wilton Place Dublin.</p>										130	0	0
<p>SEE ESTIMATE DATED 10TH MAY 1916 FROM MESSRS WILLIAM BECKETT & SON LTD., SENT HEREWITH.</p>												
<p>Additional claim</p>										146	1	8
										286	1	8
<p><i>Carried forward.</i></p>												

FANE VERNON—Agent.

Telephone No. 565.

Enclosures.

PEMBROKE ESTATES OFFICE,

1 Wilton Place,

DUBLIN.

227.

Various

227

227

July 6. 1916.

re Damage to the building of the Estate Office and Agent's House,
1 Wilton Place, Dublin,
occasioned by rifle fire from the troops on 30th April 1916.

Dear Sir,

Herewith I beg to send form of claim, in duplicate, in respect of the above, duly filled up by me, as Agent for the Earl of Pembroke and Montgomery, who is at present serving with the British Expeditionary Force in France. I also enclose Messrs. William Beckett & Son's Estimate of the 10th of May last, together with copy of same, and the Liverpool & London & Globe Insurance Company's Policies numbered 2924455 and 11690763, respectively. The latter Policy was taken out, in order that the property should be fully covered, when the prices of building materials etc. were raised.

Should you desire to have any further particulars, I shall, on hearing from you, be happy to furnish same.

Faithfully yours,

Fane Vernon

The Secretary,

Property Losses (Ireland) Committee, 1916.

51, St. Stephen's Green, East,

Dublin.

Statement of Claim of the Earl of Pembroke and Montgomery in respect of damage caused by rifle fire to the Estate Office and private dwelling house situate 1 Wilton Place, his lordship's property, on Sunday, 30th April 1916.

Valuation of the damage to the front of the buildings, broken windows, and injury to internal walls and decorations, as estimated by Messrs. William Beckett & Son, Percy Works, Dublin

£130: 0: 0



Majr Tarry.

The receipt of these two claims has been acknowledged saying they will be forwarded to the Civil authorities in the usual course -
 Per Mtr's liability LMT 30/5.

64153 (Q).



CHIEF SECRETARY'S
9209 - 31.MAY.1916
OFFICE

Headquarters,

Irish Command,

Parkgate,

Dublin. 30th May, 1916.

HEADQUARTERS, IRISH COMMAND
30 MAY 1916
PARKGATE, DUBLIN.

Sir,

In continuation of this office memo No.64153 (Q) dated 4th May, 1916, I have the honour to forward herewith claim of the Earl of Pembroke and Montgomery for damage to his property 1 Wilton Place and also claim of Fane/Vernon occupant of said premises in respect of damage to household effects.

detacher

I have the honour to be,

Sir,

Your obedient Servant,

Edw Smith

Major General

i/c Administration, Irish Command.

Under Secretary,

Dublin Castle.

*Von file
Cody
31-5-16*

Fire Loss No. 227

Name, EARL OF PEMBROKE AND MONTGOMERY

Address,

AGENT:-

Fane Vernon, Pembroke Estates Office,
1, Wilton Place, Dublin 'Phone
565

22/one
Bick don't
Miss G...

R. N. KENNEDY,

FIRE LOSS ASSESSOR

(For Insured only),

OCEAN BUILDINGS,

Belfast.

Fire Loss No. 227

Name, EARL OF PEMBROKE.

Address,

POLICIES.

11690763	"LIVL. LONDON & GLOBE"	
	ON Building of Private dwellinghouse, 1, Wilton Place Dublin.	400
	ON Building of Pembroke Estate office, sit. Wilton Terrace.	400
2924455	"LIV. LONDON & GLOBE"	
	ON Building of No. 1 Wilton Place.	2000
	ON Building of Pembroke Estate office.	2000
	ON Building of Stable at rere	400
		£5200

R. N. KENNEDY,

FIRE LOSS ASSESSOR

(For Insured only),

OCEAN BUILDINGS,

Belfast.

Fire Loss No. 227

Name, EARL OF PEMBROKE & MONTGOMERY

Address, ADDITIONAL CLAIM.

AGENT:-

Fane Vernon, Pembroke Estates Offices,
1, Wilton Place, Dublin, 'phone 565.

R. N. KENNEDY,
LOSS ASSESSOR,
3 COLLEGE GREEN,
DUBLIN.

Property Losses (Ireland) Committee, 1916.